

## TOUR GUIDE TO LEED FEATURES

This printed tour will take you to highlighted LEED\* features around the Commons Center's accessible areas. The tour takes 20-25 minutes. The first information sign is located at the top of the stairs in the atrium (#1 on the map). Read about the building's environmentally-sustainable features at each information sign.

The sign numbers on the map are in sequence with the *Video Walking Tour* and the *MP3 Audio Tour* available for download at the Commons Center information desk or at [www.vanderbilt.edu/SustainVU](http://www.vanderbilt.edu/SustainVU). This brochure is available as an alternative to the downloadable tour versions. Read about the building's sustainable features at each information sign. Once you have completed the tour, please return the reusable brochures to allow others to take the tour.



*The Commons Center Atrium*

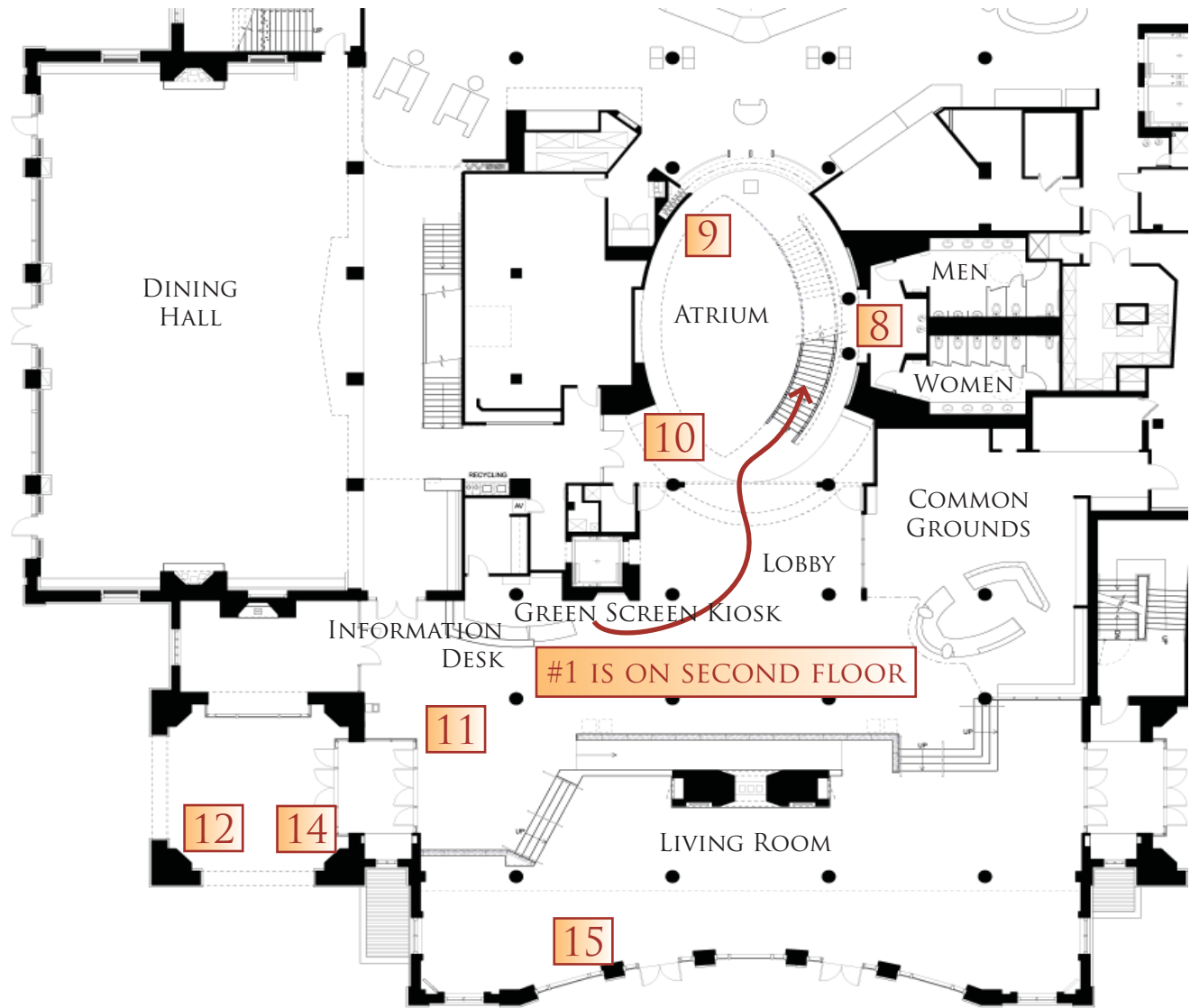

13

BIKE RACKS

FIRST FLOOR  
THE COMMONS CENTER

· green screen tour ·

\*The Leadership in Energy and Environmental Design (LEED) Green Building Rating System, developed by the U.S. Green Building Council, provides a suite of standards for environmentally sustainable construction.

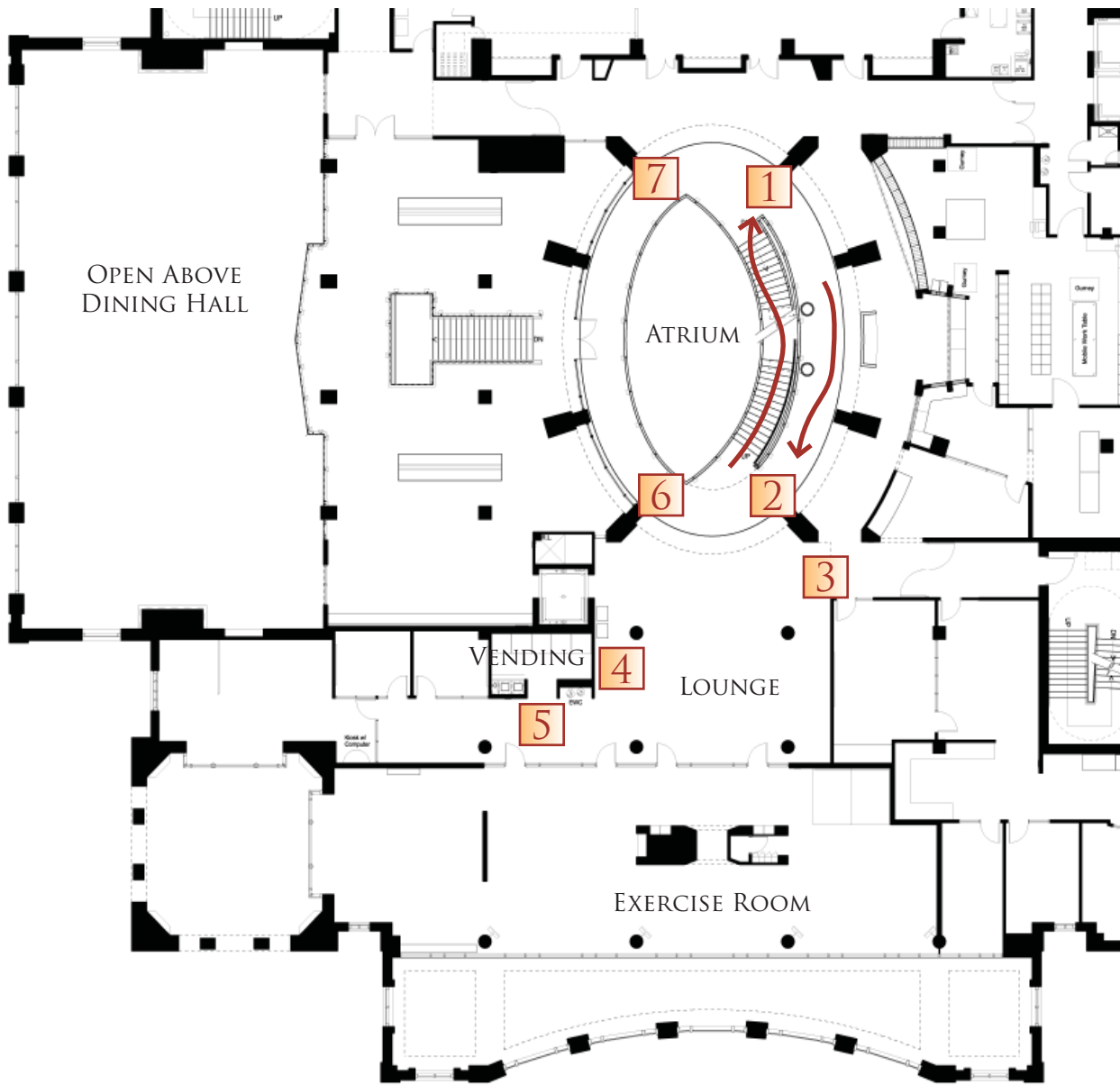

SECOND FLOOR  
THE COMMONS CENTER

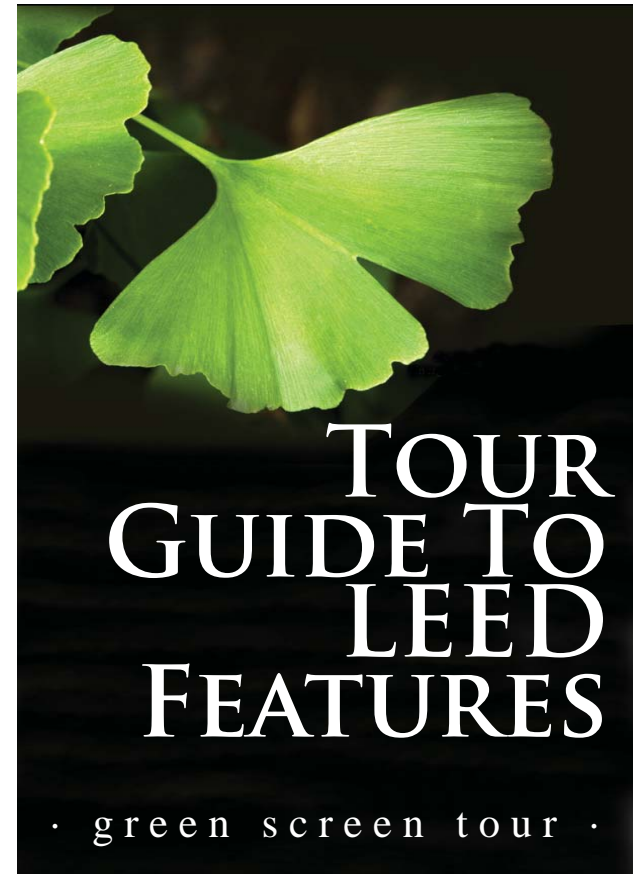

THE COMMONS CENTER  
VANDERBILT UNIVERSITY